

# STE MODELS 2-PANEL TUB SLIDER

**SIX**  
6 MM GLASS

**STANDARD HEIGHT IS 55 1/2"**  
(UNLESS OTHERWISE NOTED)

## CLEAR (C) GLASS LIST PRICING FOR OTHER GLASS TYPES REFER TO OPTIONS

MODEL #	WIDTH <sup>(1, 2)</sup>	SILVER (S)	BRUSHED NICKEL (BN), GOLD (G), SATIN SILVER (SS)	MATTE BLACK (MB), OIL RUB BRONZE (ORB)	DESIGNER COLOURS
<b>STE-54</b>	50" - 54"	1,200.00	1,350.00	1,500.00	CONTACT FOR PRICING
<b>STE-54-58.5</b> (HEIGHT = 58 1/2")	50" - 54"	1,300.00	1,450.00	1,600.00	
<b>STE-56</b>	52" - 56"	1,200.00	1,350.00	1,500.00	
<b>STE-56-51</b> (HEIGHT = 51")	52" - 56"	1,600.00	1,750.00	1,900.00	
<b>STE-58</b>	54" - 58"	1,200.00	1,350.00	1,500.00	
<b>STE-60</b>	56" - 60"	1,200.00	1,350.00	1,500.00	
<b>STE-64</b>	60" - 64"	1,200.00	1,350.00	1,500.00	
<b>STE-64-54.5</b> (HEIGHT = 54 1/2")	60" - 64"	1,600.00	1,750.00	1,900.00	
<b>STE-66</b>	62" - 66"	1,200.00	1,350.00	1,500.00	
<b>STE-66-51</b> (HEIGHT = 51")	62" - 66"	1,600.00	1,750.00	1,900.00	
<b>STE-72</b>	68" - 72"	1,300.00	1,450.00	1,600.00	
<b>STE-Q</b> FILL OUT CUSTOM DOOR QUOTE REQUEST FORM AND SUBMIT WITH ORDER	UP TO 66" UP TO 72"	1,300.00 1,400.00	1,450.00 1,550.00	1,600.00 1,700.00	

**NOTES -**

- Order as model # followed by option suffix, example: **STE-60-58.5-DBB-LH-S/C-EC10**
- Refer to specification sheet for complete product information.
- (1) Prior to ordering, confirm that enclosure's adjustment range fits both top and bottom width of finished opening.
- (2) If walls are not flat, filler jambs may be required, contact for more info.

OPTIONS		
SUFFIX	DESCRIPTION	LIST \$
	DESIGNER GLASS -	
O, R	OBSCURE, RAIN	150.00
BR, GY	BRONZE, GRAY	200.00
SE, ST	SATIN ETCH, STARPHIRE	500.00
BB, GL	BUBBLES, GLUECHIP	1,100.00
NR	NARROW REED	1,800.00
SC2, SC3	SOFT CURVE - 2 BUMP, 3 BUMP	600.00
EC10	EASYSLEAK10 GLASS TREATMENT	300.00
	DESIGNER HANDLES	p. 65
FH	FLUTED (TRADITIONAL) HEADER	N/C
F	FILLER JAMB <sup>(2)</sup>	115.00
58.5	58-1/2" HEIGHT	100.00
	CUSTOM HEIGHT UP TO 65-1/2"	400.00

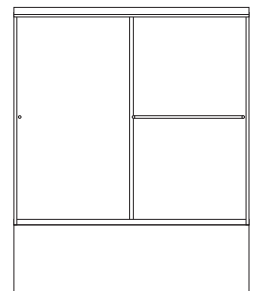

STE