

STANDARD HEIGHT IS 55 1/2"  
(UNLESS OTHERWISE NOTED)

**CLEAR (C) GLASS LIST PRICING**  
FOR OTHER GLASS TYPES REFER TO OPTIONS

MODEL # <sup>(1)</sup>	WIDTH <sup>(2, 3)</sup>	SILVER (S)	BRUSHED NICKEL (BN), GOLD (G), SATIN SILVER (SS)	MATTE BLACK (MB), OIL RUB BRONZE (ORB)	DESIGNER COLOURS
ETE-54	50" - 54"	2,200.00	2,350.00	2,500.00	CONTACT FOR PRICING
ETE-54-57.5 (HEIGHT = 57 1/2")	50" - 54"	2,300.00	2,450.00	2,600.00	
ETE-56	52" - 56"	2,200.00	2,350.00	2,500.00	
ETE-56-51 (HEIGHT = 51")	52" - 56"	2,650.00	2,800.00	2,950.00	
ETE-58	54" - 56"	2,200.00	2,350.00	2,500.00	
ETE-60	56" - 60"	2,200.00	2,350.00	2,500.00	
ETE-64	60" - 64"	2,200.00	2,350.00	2,500.00	
ETE-64-54.5 (HEIGHT = 54 1/2")	60" - 64"	2,650.00	2,800.00	2,950.00	
ETE-66	62" - 66"	2,200.00	2,350.00	2,500.00	
ETE-66-51 (HEIGHT = 51")	62" - 66"	2,650.00	2,800.00	2,950.00	
ETE-72	68" - 72"	2,300.00	2,450.00	2,600.00	
ETE-Q FILL OUT CUSTOM DOOR QUOTE REQUEST FORM AND SUBMIT WITH ORDER	UP TO 66" UP TO 72"	2,300.00 2,400.00	2,450.00 2,550.00	2,600.00 2,700.00	

NOTES -

- Order as model # followed by option suffix, example: **ETE-60-57.5-DBB-LH-S/C-EC10**
- Refer to specification sheet for complete product information.
- (1) Specify shower head location, left side (suffix **-LH**) or right side (suffix **-RH**).
- (2) Prior to ordering, confirm that enclosure's adjustment range fits both top and bottom width of finished opening.
- (3) If walls are not flat, filler jambs may be required, contact for more info.

OPTIONS		
SUFFIX	DESCRIPTION	LIST \$
R	DESIGNER GLASS -	
	RAIN	550.00
BR, GY	BRONZE, GRAY	550.00
BB, GL	BUBBLES, GLUECHIP	850.00
SE, ST	SATIN ETCH, STARPHIRE	1,150.00
SC2, SC3	SOFT CURVE - 2 BUMP, 3 BUMP	600.00
EC10	EASYSLEAK10 GLASS TREATMENT	300.00
	DESIGNER HANDLES	p. 65
F	FILLER JAMB <sup>(3)</sup>	115.00
57.5	57-1/2" HEIGHT	100.00
	CUSTOM HEIGHT UP TO 65-1/2"	450.00

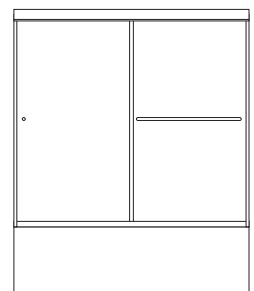

ETE