

# PRE-INSTALLATION

## SHOWER DOOR LOCATION

The first thing to consider prior to ordering a Hy-Line Shower Door is determining where it will be located. The centre line, that is, the location on the opening where you want to position the door, is not always the centre of the opening's curb. You may want the centre line to follow a grout line, be located on the back of the buttress to make a shelf for shampoo bottles, or be positioned to allow for a bench for sitting. See Figure #1 for centre line location examples.

Be mindful of extrusion dimension, making sure that it will not extend past tile or fabricated enclosure surfaces. Typically the centre line should be no less than 1" from an edge, 1-1/2" if Euro header used.

Figure #1

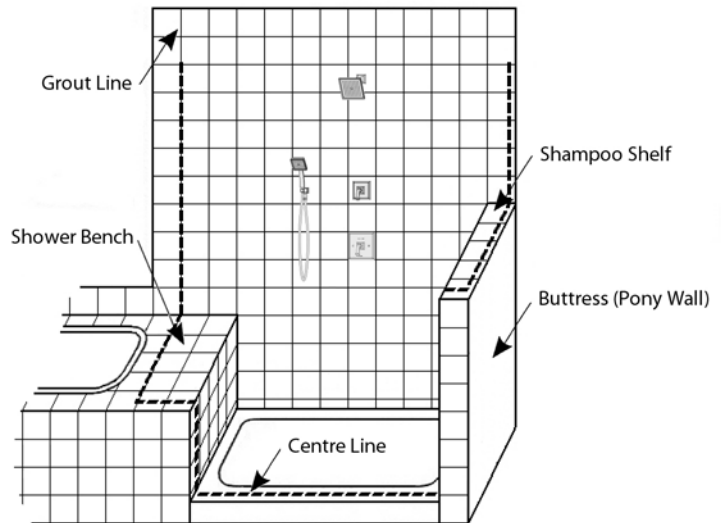

## SPECIAL CONSIDERATIONS FOR PIVOT/HINGE DOORS

If the shower enclosure includes a pivot door, the location of the door may be influenced by an adjacent fixture, cabinetry, furniture, shower bench or shower head's spray direction. See Figure #2.

Figure #2

Example of off-centre right hand swing hinge door.

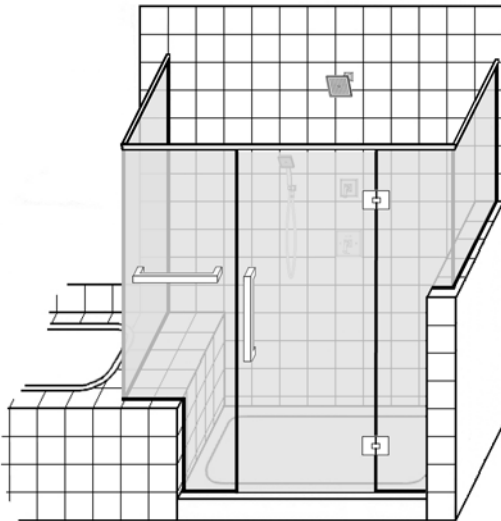

FIVE, SIX & HL series pivot doors are reversible, which means that the swing direction can be reversed without requiring modification. However, if ClearShield treated glass, textured glass, or designer hardware options are required, the swing direction will need to be identified prior to fabrication. Swing direction is identified by which side of the pivot door the hinge will be mounted, when standing outside the shower facing the door. See Figure #2.

FIVE, SIX & HL series -180 inline models can be installed with the pivot door on either the left or right side of the opening, while -280 inline models have the pivot door mounted in the centre. Pivot doors can also be custom manufactured off-center. In this case, specific dimensions are required.

FIVE, SIX & HL series pivot doors are provided with specific pivot door widths. If circumstances require a narrower or larger pivot opening, we can likely accommodate it. Again, specific dimensions are required. Be aware though that there are limitations due to the weight that a door hinge can carry, or the minimum glass width that we can produce. Contact us for assistance.

These issues must also be considered for TEN series pivot doors, however because they are custom designed and must be installed by a professional installer, we will work with you in resolving these issues prior to manufacture.

Continued...

# PRE-INSTALLATION

## STRUCTURAL REQUIREMENTS

The installation of a Hy-Line Shower Door is made easier with level wall and curb (threshold) surfaces. It is recommended that double 2x4 framing be installed where the shower door will be located. This framing is mandatory for HL10 & TEN series doors, especially for wall mounted hinges. See Figure #3a. Framing is also required for HL10 series wall braces. See Figure #3b.

Note that TEN series hinge doors can not be installed on fabricated bath or shower enclosures.

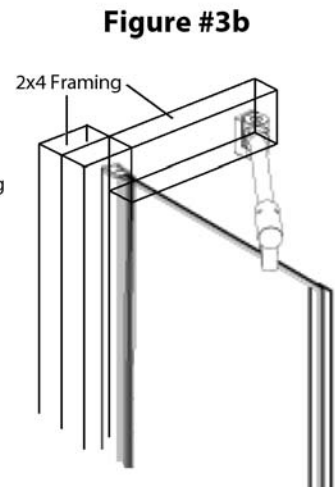
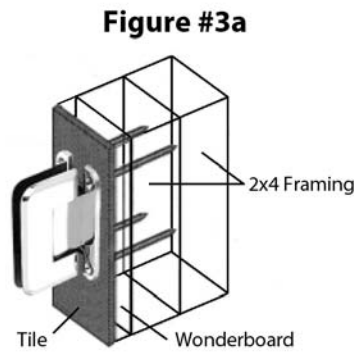

# MEASURE-UP

Accurately measuring the shower enclosure's finished opening dimensions is critical to providing the best possible fitting Hy-Line Shower Door.

## OVERALL WIDTH

Overall width is the distance between finished wall surfaces. Sometimes this distance is broken up into segments, such as where the door changes direction, i.e. -90, -290 doors and neo-angle doors, or where it rises on to a buttress, i.e. -90B and -290B doors.

Walls are rarely plumb, meaning that they can "fall-in", top of the wall leans into the opening, or can "fall-out", top leans away from the opening. Because of this, it is imperative to measure both the bottom and top centre line locations and to measure the wall's "fall-in" or "fall-out" dimension (offset distance).

Measure at 1" to 2" above the curb, and where the top of the door will be located. For the overall height of a specific door model, refer to its specification sheet. Place a four foot level and door height straight edge against the wall to measure the offset distance. See Figure #4.

For panels that are inline with the pivot door but are located on a buttress, measure the dimension from buttress edge to finished wall or to the centre line of a return panel. This is called the notch length. The buttress wall may not be plumb and will need to be measured for offset distance also.

Figure #4

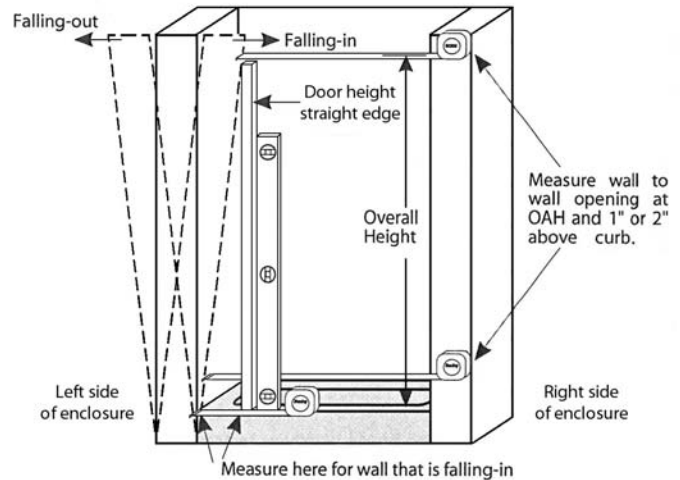

## OVERALL HEIGHT

Overall height is the distance between finished curb and top of door. Like walls, the curb may not be level, therefore it is imperative to measure both left and right side centre line heights from the same top elevation. Measure any offset in the curb with a level and measure the difference in elevation from the curb to the upper surface of the buttress (called the riser height). See Figure #4.

## SPECIAL CONSIDERATIONS

FIVE, SIX & HL series doors come with adjustable wall jambs that can accommodate walls that are up to 1/2" off-plumb, however if the offset distance is greater than 1/2", a filler jamb will need to be used. TEN series doors will have to be manufactured according to finished wall conditions.

If the enclosure includes a decorative bull nose or raised tile, or if tile has not been finished flush with tub or shower flange, a filler jamb will also be required.