

ENCLOSURE DESIGN

ENCLOSURE LOCATION

The first thing to consider prior to ordering a Hy-Line Shower Door is determining where it will be located. The centre line, that is, the location on the opening where you want to position the door, is not always the centre of the opening's curb. You may want the centre line to follow a grout line, be located on the back of the buttress to make a shelf for shampoo bottles, or be positioned to allow for a bench for sitting. See Figure #1 for centre line location examples.

Be mindful of extrusion dimension, making sure that it will not extend past tile or fabricated enclosure surfaces. Typically the centre line should be no less than 1" from an edge, 1-1/2" if Euro header used.

Figure #1

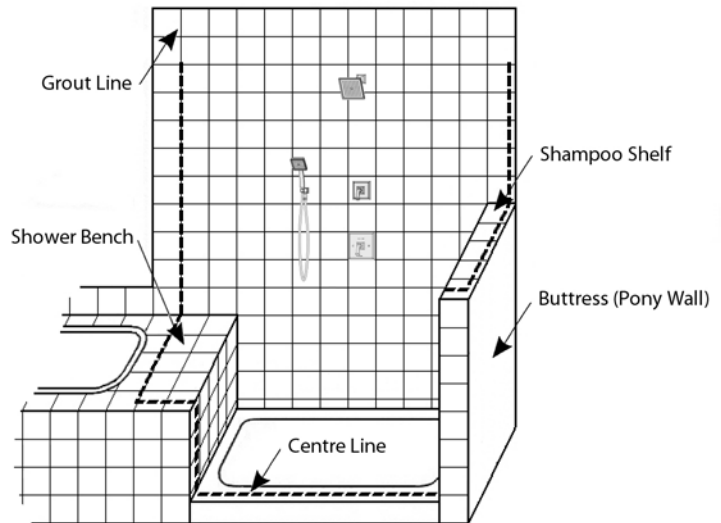

SPECIAL CONSIDERATIONS FOR PIVOT/HINGE DOORS

If the shower enclosure includes a pivot door, the location of the door may be influenced by an adjacent fixture, cabinetry, furniture, shower bench or shower head's spray direction. See Figure #2.

Figure #2

Example of off-centre right hand swing hinge door.

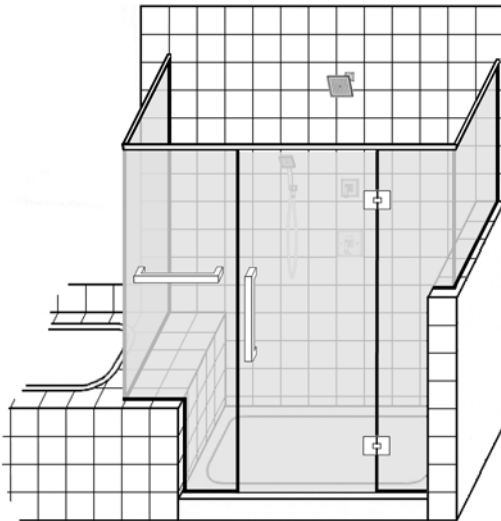

FIVE, SIX & HL series pivot doors are reversible, which means that the swing direction can be reversed without requiring modification. However, if ClearShield treated glass, textured glass, or designer hardware options are required, the swing direction will need to be identified prior to fabrication. Swing direction is identified by which side of the pivot door the hinge will be mounted, when standing outside the shower facing the door. See Figure #2.

FIVE, SIX & HL series -180 inline models can be installed with the pivot door on either the left or right side of the opening, while -280 inline models have the pivot door mounted in the centre. Pivot doors can also be custom manufactured off-center. In this case, specific dimensions are required.

FIVE, SIX & HL series pivot doors are provided with specific pivot door widths. If circumstances require a narrower or larger pivot opening, we can likely accommodate it. Again, specific dimensions are required. Be aware though that there are limitations due to the weight that a door hinge can carry, or the minimum glass width that we can produce. Contact us for assistance.

These issues must also be considered for TEN series pivot doors, however because they are custom designed and must be installed by a professional installer, we will work with you in resolving these issues prior to manufacture.